

征收土地预公告附图

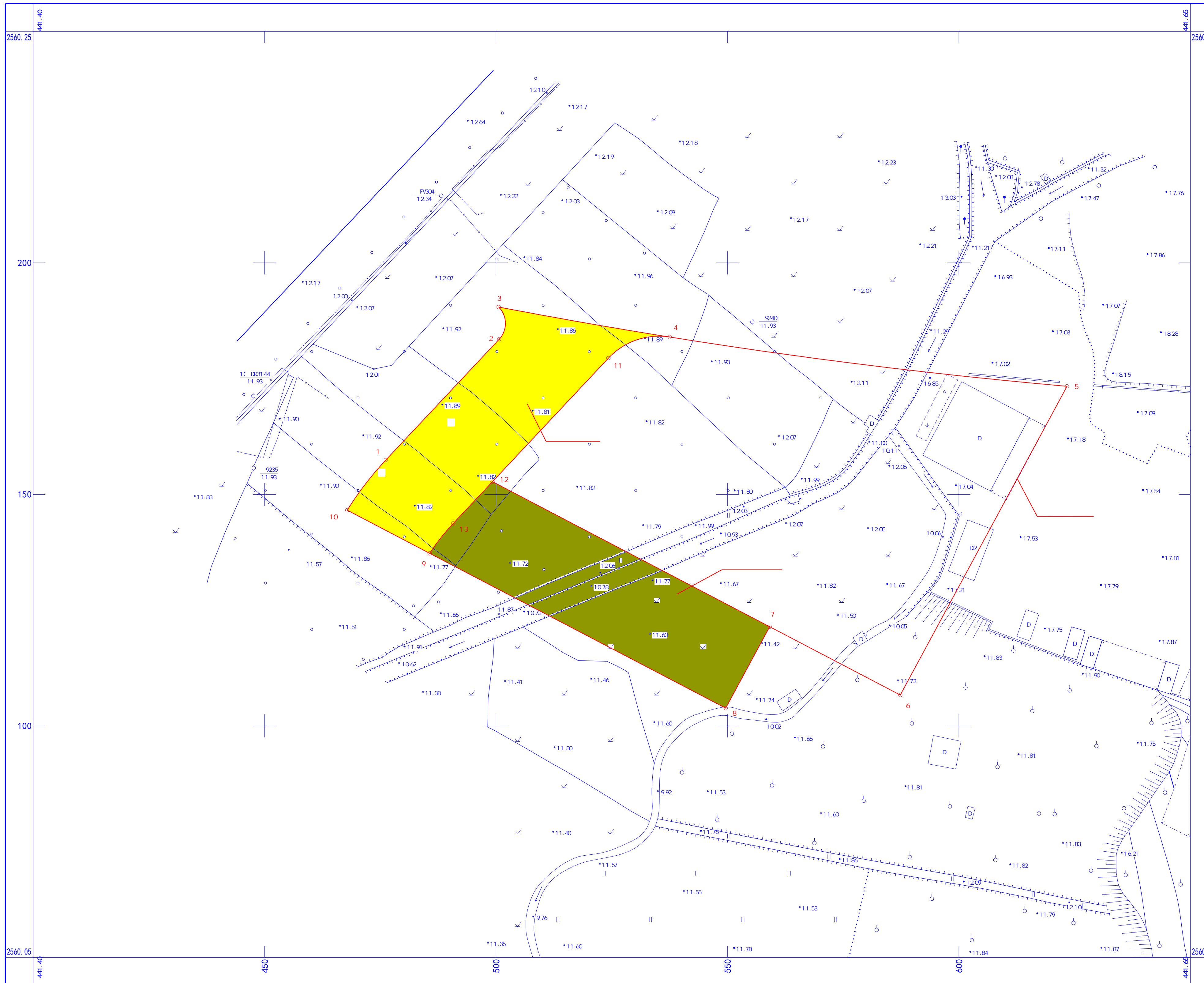

13							
2000				2000			
	X(m)	Y(m)		X(m)	Y(m)		
1	230429.503	54856.321	25601.57.41.4	38441.476.189			
2	230455.709	54880.680	25601.83.502	38441.500.675			
3	230462.672	54880.531	25601.90.466	38441.500.560			
4	230456.364	54917.539	25601.83.979	38441.537.539			
5	230446.149	55003.401	25601.73.348	38441.623.254			
6	230379.295	54967.703	25601.06.665	38441.587.331			
7	230393.915	54939.419	25601.21.422	38441.559.117			
8	230376.271	54929.998	25601.03.823	38441.549.610			
9	230409.413	54865.878	25601.37.277	38441.485.649			
10	230418.634	54848.039	25601.46.584	38441.467.854			
11	230451.746	54904.302	25601.79.425	38441.524.279			
12	230424.944	54879.389	25601.52.743	38441.499.236			
13	230415.887	54870.970	25601.43.726	38441.490.772			
6				6			
	X(m)	Y(m)	(m)	X(m)	Y(m)	(m)	(m)
1.01	230424.271	54851.914	70.00	1.01	25601.52.203	38441.471.756	70.00
2.3	230459.220	54882.017	5.00	2.3	25601.87.007	38441.502.029	5.00
3.4	230459.376	54899.011	120.00	3.4	25601.87.081	38441.519.025	120.00
4.5	230450.502	54900.380	120.00	4.5	25601.77.910	38441.580.353	120.00
1.3.9	230412.755	54868.290	50.00	1.3.9	25601.40.607	38441.488.077	50.00
4.1.1	230455.696	54910.348	15.00	4.1.1	25601.83.346	38441.530.344	15.00
2000				2000			
8054.84				8055.47			
1249.03				1249.10			
1402.71				1402.82			
5403.10				5403.55			
201 9 32B056							
1 : 500							
201 9 7							
2000							