

广州市花都区土地开发储备中心土地芙蓉大道东一地块征地预告附图

2594.0-419.4

业务号：2018001

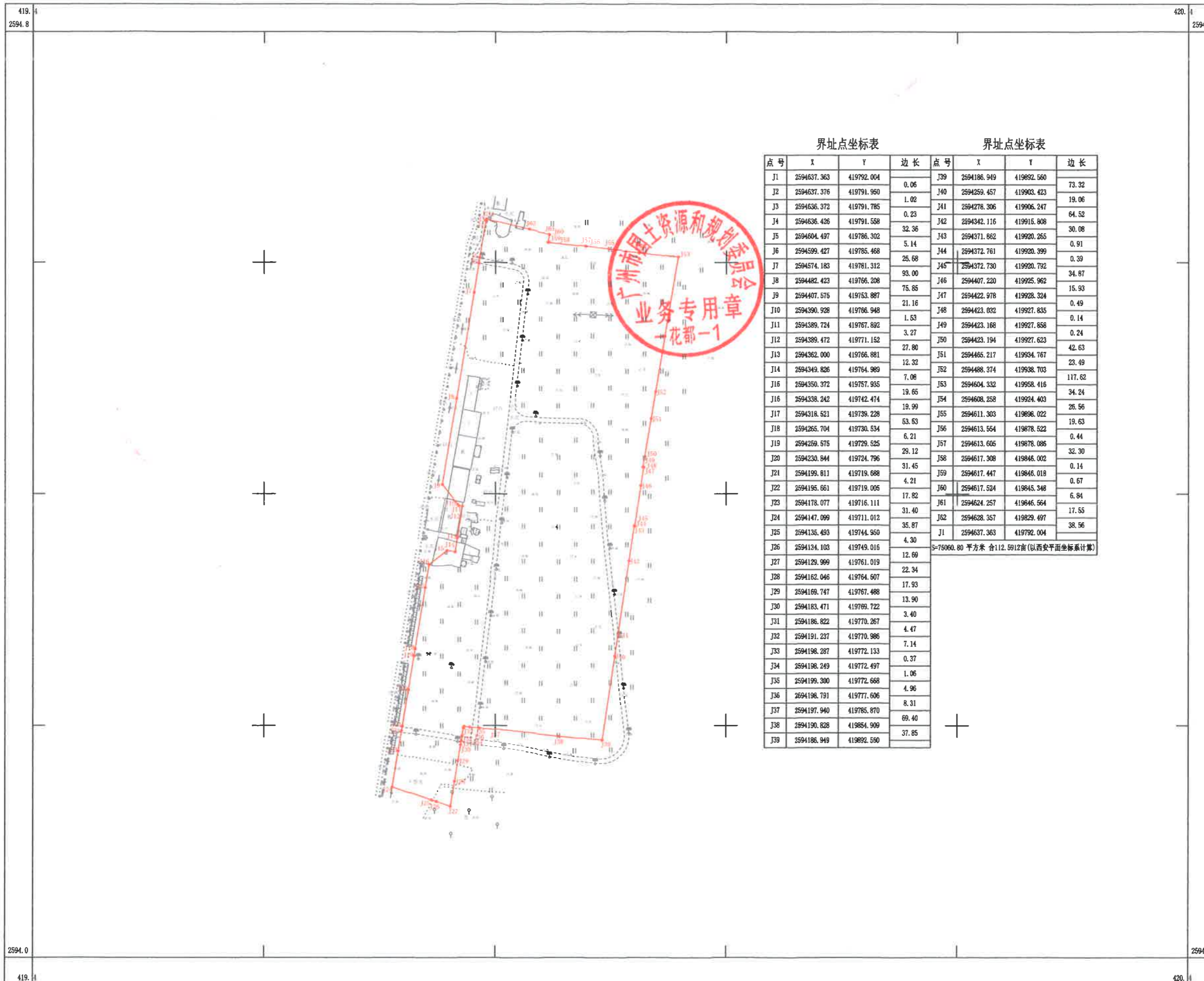

界址点坐标表

界址点坐标表

点号	X	Y	边长	点号	X	Y	边长
J1	2594637.363	419792.004	0.06	J39	2594186.949	419892.560	73.32
J2	2594637.376	419791.950	1.02	J40	2594259.457	419903.423	19.06
J3	2594636.372	419791.785	0.23	J41	2594276.306	419906.247	64.52
J4	2594636.426	419791.558	32.36	J42	2594342.116	419915.908	30.08
J5	2594604.497	419786.302	5.14	J43	2594371.862	419920.265	0.91
J6	2594599.427	419785.468	26.68	J44	2594372.761	419920.399	0.39
J7	2594574.183	419781.312	93.00	J45	2594372.730	419920.792	34.87
J8	2594482.423	419766.208	75.85	J46	2594407.220	419925.962	15.93
J9	2594407.575	419753.887	21.16	J47	2594422.978	419928.324	0.49
J10	2594390.928	419766.948	1.53	J48	2594423.032	419927.835	0.14
J11	2594389.724	419767.892	3.27	J49	2594423.168	419927.858	0.24
J12	2594389.472	419771.152	27.80	J50	2594423.194	419927.623	42.63
J13	2594362.000	419766.881	12.32	J51	2594465.217	419934.767	23.49
J14	2594349.826	419764.989	7.08	J52	2594488.374	419938.703	117.62
J15	2594350.372	419757.935	19.65	J53	2594604.332	419958.416	34.24
J16	2594338.242	419742.474	19.99	J54	2594608.258	419924.403	26.56
J17	2594318.521	419739.228	53.53	J55	2594611.303	419898.022	19.63
J18	2594265.704	419730.534	6.21	J56	2594613.554	419878.522	0.44
J19	2594259.575	419729.525	29.12	J57	2594613.605	419878.086	32.30
J20	2594230.844	419724.796	31.45	J58	2594617.308	419846.002	0.14
J21	2594199.811	419719.688	4.21	J59	2594617.447	419846.018	0.67
J22	2594195.661	419719.005	17.82	J60	2594617.524	419845.348	6.84
J23	2594178.077	419716.111	31.40	J61	2594624.257	419846.564	17.55
J24	2594147.099	419711.012	35.87	J62	2594628.357	419829.497	38.56
J25	2594135.493	419744.950	4.30	J1	2594637.363	419792.004	
J26	2594134.103	419749.016	12.69	S=75060.80 平方米 合112.5912亩(以西安平面坐标系计算)			
J27	2594129.999	419761.019	22.34				
J28	2594162.046	419764.607	17.93				
J29	2594169.747	419767.488	13.90				
J30	2594183.471	419769.722	3.40				
J31	2594186.822	419770.267	4.47				
J32	2594191.237	419770.986	7.14				
J33	2594198.287	419772.133	0.37				
J34	2594198.249	419772.497	1.06				
J35	2594199.300	419772.668	4.96				
J36	2594198.791	419777.606	8.31				
J37	2594197.940	419785.870	69.40				
J38	2594190.828	419854.909	37.85				
J39	2594186.949	419892.560					

广州科测测绘技术有限公司

1980西安坐标系
1985国家高程基准

1:2000

制图日期:2018年7月20日