

点号	X	Y	边长
J1	2624797.957	470974.328	109.45
J2	2624797.424	471083.777	
J3	2624753.028	471087.007	44.51
J4	2624747.637	471001.972	85.21
J5	2624747.985	470974.328	27.65
J1	2624797.957	470974.328	49.97
S=5333.34 平方米 约8.0000亩			

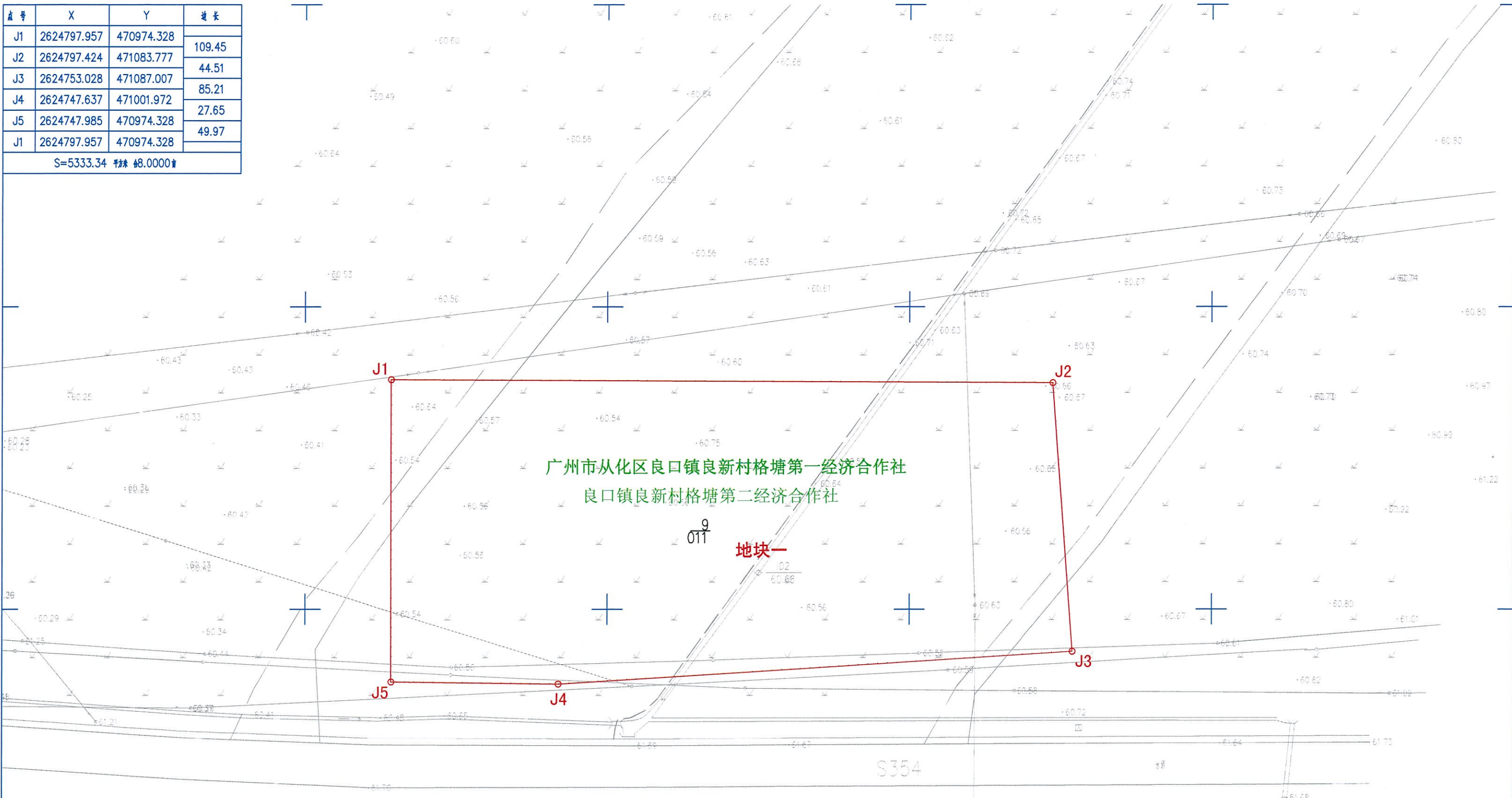

**红线内土地面积为5333.340平方米；
 全部为广州市从化区良口镇良新村格塘第一经济合作社，
 广州市从化区良口镇良新村格塘第二经济合作社集体土地。**

图斑编号 1
 地类代码 203
 征地红线 ———
 界址点符号 J1
 地类界线 ———
 权属界线 集体

序号	X	Y	面积	序号	X	Y	面积
J1	2824542.135	474876.923	13.78	J98	2824293.881	474963.086	9.34
J2	2824570.121	474888.486	86.82	J97	2824257.884	474877.915	2.94
J3	2824480.430	474837.177	83.08	J96	2824256.242	474956.385	30.94
J4	2824427.401	474839.580	18.87	J95	2824228.594	474929.842	14.38
J5	2824407.430	474839.946	14.84	J100	2824219.829	474940.698	22.24
J6	2824385.984	474848.063	13.20	J101	2824201.936	474853.801	58.01
J7	2824385.785	474862.257	22.21	J102	2824144.997	474864.903	24.80
J8	2824373.574	474862.187	13.77	J103	2824124.487	474978.850	23.02
J9	2824359.833	474861.246	30.52	J104	2824116.341	475000.395	70.44
J10	2824359.833	474891.763	34.90	J105	2824134.284	475068.511	9.71
J11	2824359.833	474826.650	77.34	J106	2824143.958	475088.968	46.04
J12	2824432.385	474953.417	25.72	J107	2824184.808	475027.918	14.99
J13	2824456.063	474963.478	45.04	J108	2824157.594	475013.842	23.32
J14	2824463.062	474986.185	25.87	J109	2824177.730	475000.006	16.48
J15	2824507.734	475010.233	20.02	J110	2824191.263	475014.015	33.42
J16	2824515.980	475028.474	13.23	J111	2824171.922	475040.987	24.80
J17	2824522.048	475040.233	13.00	J112	2824182.201	475053.387	34.21
J18	2824523.889	475053.103	8.44	J113	2824159.830	475089.253	53.80
J19	2824523.211	475061.514	8.44	J114	2824175.603	475140.694	19.58
J20	2824522.552	475066.925	14.88	J115	2824194.685	475136.318	24.51
J21	2824514.191	475082.238	65.25	J116	2824197.653	475180.646	42.52
J22	2824473.867	475133.531	22.35	J117	2824188.478	475201.873	10.53
J23	2824466.631	475155.477	18.53	J118	2824190.848	475211.249	9.37
J24	2824451.422	475158.898	20.31	J119	2824200.190	475211.955	30.80
J25	2824447.363	475138.116	1.18	J120	2824230.713	475216.059	60.69
J26	2824448.800	475137.240	15.43	J121	2824261.215	475288.538	6.52
J27	2824433.184	475137.753	20.31	J122	2824257.328	475273.778	12.94
J28	2824412.990	475135.584	10.17	J123	2824250.451	475284.738	15.86
J29	2824414.077	475125.489	0.56	J124	2824244.543	475289.481	13.50
J30	2824414.378	475124.991	1.08	J125	2824244.444	475312.980	4.81
J31	2824414.848	475124.077	1.13	J126	2824248.027	475315.963	6.31
J32	2824415.558	475123.122	1.21	J127	2824253.329	475315.519	6.75
J33	2824416.132	475122.081	1.02	J128	2824256.647	475310.821	4.12
J34	2824416.635	475121.174	0.96	J129	2824261.083	475302.881	14.30
J35	2824417.114	475120.344	0.96	J130	2824266.787	475294.277	8.38
J36	2824417.548	475119.489	0.98	J131	2824273.573	475286.361	8.12
J37	2824417.989	475118.613	0.82	J132	2824281.607	475288.190	7.67
J38	2824418.382	475117.778	1.02	J133	2824289.095	475289.829	10.56
J39	2824418.801	475116.850	1.13	J134	2824297.293	475296.491	8.72
J40	2824419.236	475115.804	1.53	J135	2824302.783	475303.281	9.73
J41	2824419.787	475114.378	1.38	J136	2824308.106	475311.408	10.38
J42	2824420.380	475113.115	1.64	J137	2824312.824	475320.658	9.35
J43	2824420.995	475111.599	1.52	J138	2824318.904	475328.071	10.99
J44	2824421.536	475110.179	1.48	J139	2824323.503	475337.856	9.65
J45	2824422.033	475108.807	1.72	J140	2824329.128	475345.700	7.97
J46	2824422.598	475107.181	1.80	J141	2824334.499	475351.817	9.79
J47	2824423.247	475105.538	2.04	J142	2824339.824	475359.932	14.94
J48	2824424.085	475103.636	1.75	J143	2824343.284	475374.421	14.10
J49	2824424.892	475102.001	1.28	J144	2824344.504	475388.464	15.87
J50	2824425.205	475100.854	1.70	J145	2824349.229	475403.219	4.65
J51	2824425.971	475099.333	1.18	J146	2824342.907	475406.054	10.24
J52	2824426.500	475098.298	1.74	J147	2824351.151	475409.992	17.38
J53	2824427.303	475096.749	1.38	J148	2824363.629	475387.928	41.94
J54	2824427.990	475095.578	1.84	J149	2824363.829	475345.990	4.29
J55	2824428.995	475094.030	1.88	J150	2824367.680	475347.410	4.83
J56	2824430.031	475092.486	1.78	J151	2824370.960	475341.930	2.12
J57	2824431.105	475091.064	1.88	J152	2824372.689	475347.919	11.06
J58	2824432.343	475089.644	2.10	J153	2824381.103	475354.910	8.85
J59	2824433.786	475088.087	2.44	J154	2824382.336	475361.181	25.58
J60	2824435.484	475086.372	2.19	J155	2824378.040	475316.901	7.83
J61	2824437.083	475084.872	2.21	J156	2824372.689	475311.198	2.96
J62	2824438.707	475083.381	1.62	J157	2824372.578	475308.238	1.79
J63	2824439.927	475082.300	2.31	J158	2824372.538	475306.448	1.53
J64	2824441.827	475080.733	1.74	J159	2824372.484	475304.919	1.84
J65	2824442.870	475079.514	1.32	J160	2824372.538	475303.064	1.84
J66	2824443.759	475078.545	1.48	J161	2824372.547	475301.448	1.37
J67	2824444.837	475077.384	1.20	J162	2824372.801	475300.074	0.78
J68	2824445.217	475076.333	1.15	J163	2824372.564	475299.281	0.70
J69	2824445.735	475075.300	1.04	J164	2824372.581	475298.591	0.42
J70	2824446.128	475074.349	0.55	J165	2824372.603	475298.177	0.80
J71	2824446.257	475073.817	0.76	J166	2824372.677	475297.384	0.87
J72	2824446.527	475073.107	1.50	J167	2824372.784	475296.517	1.65
J73	2824447.072	475071.713	0.48	J168	2824373.027	475294.886	1.88
J74	2824447.228	475071.244	0.77	J169	2824373.379	475293.037	1.82
J75	2824447.474	475070.511	0.80	J170	2824373.725	475291.254	1.95
J76	2824447.744	475069.758	1.29	J171	2824373.907	475290.323	1.98
J77	2824448.118	475068.516	0.98	J172	2824374.319	475288.403	2.37
J78	2824448.341	475067.558	0.82	J173	2824374.840	475286.092	1.53
J79	2824448.513	475066.755	7.34	J174	2824375.145	475284.592	4.12
J80	2824453.572	475061.434	27.54	J175	2824375.639	475280.547	1.52
J81	2824445.045	475035.245	17.12	J176	2824376.214	475279.058	44.54
J82	2824432.082	475024.069	12.33	J177	2824376.554	475277.238	1.67
J83	2824419.818	475022.778	62.37	J178	2824376.850	475275.592	1.98
J84	2824430.946	474981.011	78.48	J179	2824377.247	475273.680	1.73
J85	2824357.312	474834.257	6.88	J180	2824377.586	475271.917	1.78
J86	2824353.145	474840.785	17.18	J181	2824377.926	475270.224	1.98
J87	2824347.818	474856.228	10.98	J182	2824378.377	475268.299	1.90
J88	2824341.188	474865.086	23.00	J183	2824378.787	475266.441	1.98
J89	2824323.840	474880.217	18.33	J184	2824379.178	475264.511	1.98
J90	2824308.851	474892.421	13.30	J185	2824379.690	475262.607	1.91
J91	2824287.032	474908.512	21.72	J186	2824380.097	475260.745	1.74
J92	2824280.795	474921.937	25.17	J187	2824380.500	475259.056	1.89
J93	2824284.542	474993.724	12.84	J188	2824380.887	475257.407	1.48
J94	2824272.485	474983.887	14.88	J189	2824381.182	475255.968	1.28
J95	2824272.891	474968.032	9.84	J190	2824381.428	475254.706	1.22
J96	2824263.881	474965.086		J191	2824381.648	475253.504	

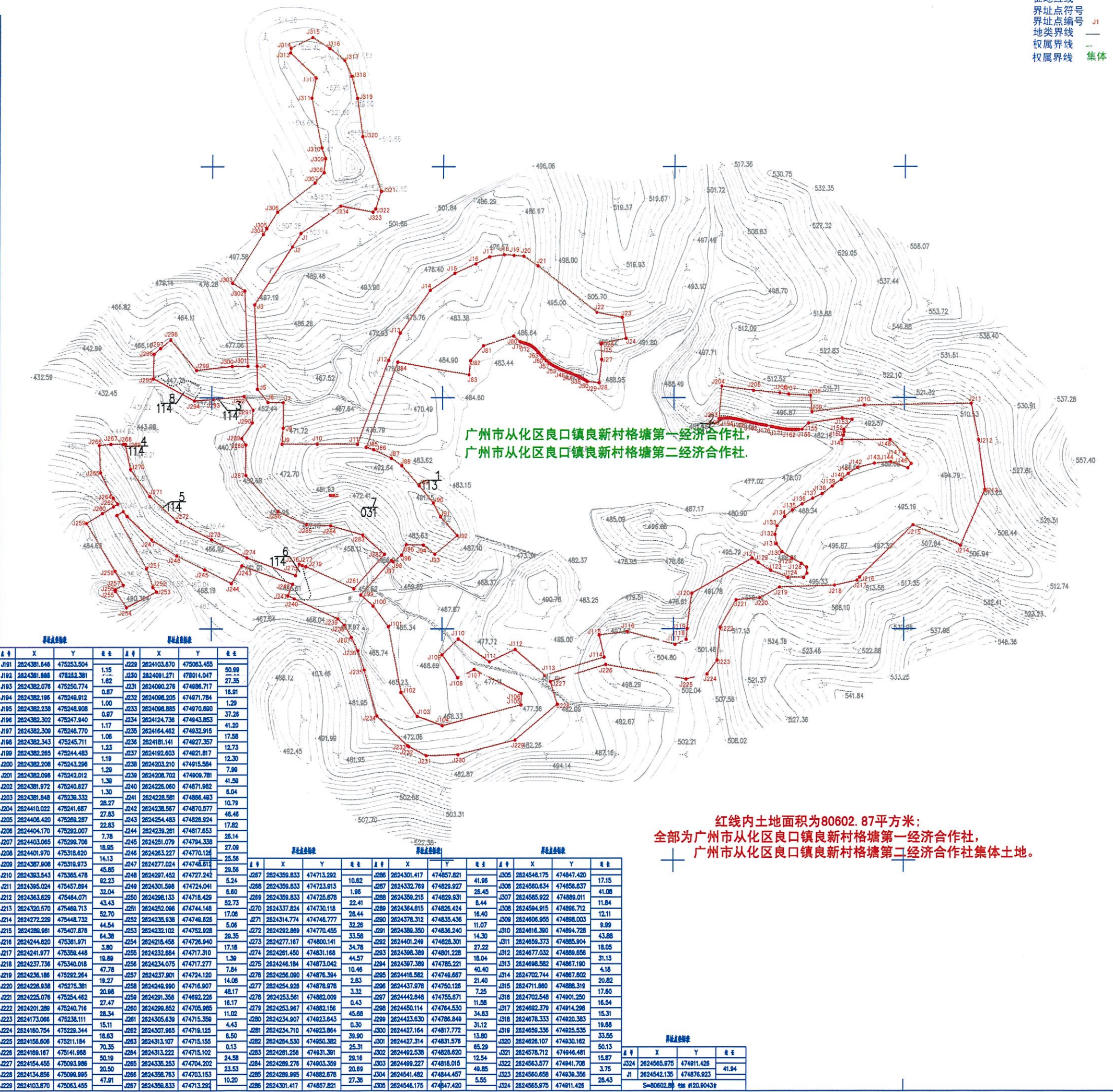

序号	X	Y	面积	序号	X	Y	面积
J91	2824381.648	475253.504	11.06	J229	2824103.870	475063.455	50.99
J92	2824381.688	475253.281	1.15	J230	2824081.271	475014.047	27.35
J93	2824382.078	475250.714	1.82	J231	2824080.278	474986.717	16.91
J94	2824382.198	475249.912	0.87	J232	2824098.205	474971.784	1.29
J95	2824382.238	475248.908	1.00	J233	2824098.885	474970.890	37.28
J96	2824382.302	475247.840	0.97	J234	2824124.738	474943.853	41.20
J97	2824382.308	475246.770	1.17	J235	2824164.462	474932.915	17.58
J98	2824382.343	475245.713	1.08	J236	2824181.141	474927.357	12.73
J99	2824382.285	475244.481	1.23	J237	2824192.803	474921.817	12.30
J200	2824382.208	475243.298	1.19	J238	2824203.210	474915.584	7.99
J201	2824382.098	475242.012	1.39	J239	2824208.702	474909.781	41.59
J202	2824381.972	475240.827	1.30	J240	2824226.060	474871.982	8.04
J203	2824381.848	475239.332	28.27	J241	2824228.581	474868.493	10.79
J204	2824410.022	475241.887	27.83	J242	2824238.567	474870.577	46.48
J205	2824406.420	475239.517	22.83	J243	2824254.483	474828.924	17.82
J206	2824404.170	475292.007	7.78	J244	2824239.281	474817.853	26.14
J207	2824383.065	475299.708	18.95	J245	2824251.079	474794.338	27.00
J208	2824401.970	475318.820	14.13	J246	2824283.227	474770.124	25.58
J209	2824387.908	475319.873	45.85	J247	2824277.024	474748.611	28.56
J210	2824383.543	475365.478	92.23	J248	2824297.452	474727.242	5.24
J211	2824395.024	475457.894	32.04	J249	2824301.598	474724.041	6.80
J212	2824383.629	475464.071	43.43	J250	2824298.133	474718.428	50.73